

A CURATED PRECINT LIKE NO OTHER.

PALOMA PALOMA

PROJECT SNAPSHOT.



1 Bulcock Street Caloundra, Sunshine Coast, Queensland.

*Disclaimer: Images shown are artist impressions and indicative only of the generally intended development, not to be relied on as a guarantee or representation that a prospective purchaser will receive the view, development layout, specification and/or construction depicted. The actual view, development layout, specification and construction may vary materially from the image depicted.

THE CONCEPT.

*Paloma Paloma is
where lifestyle,
meets luxury.*

Here at the southern end of the Sunshine Coast, visionary architecture and design elegantly collide to offer 74 oversized residences, exceptional retail and dining experiences and a separate world-class hotel.

A curated lifestyle precinct like no other, Paloma Paloma invites you to enjoy endless horizons and cooling coastal breezes amongst the Sunshine Coast's newest place to be.

*Totally
Unexpected.*



*Artist Impression.

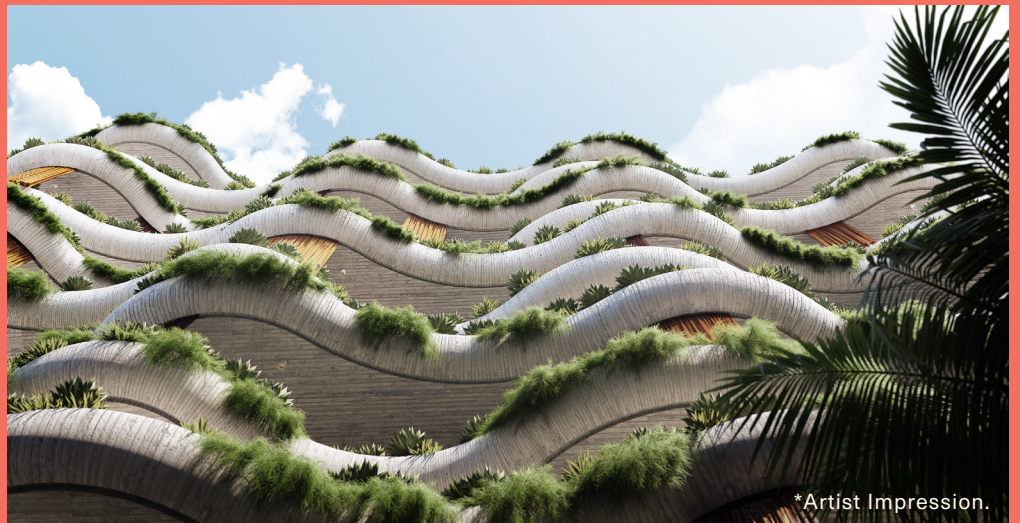

*Artist Impression.

PROJECT OVERVIEW.

Cura Habitas has assembled a team of The Stella Collective, Decibel Architecture and LatStudios to design and deliver this game changing project.

- Sought-after coastal location close to local amenity.
- 74 oversized 2, 3 & 4 bedroom residences over 14 levels.
- Three levels of retail and dining amenity including bars, dining venues, hotel convention centre, fitness & yoga centre and wellbeing spa.
- 110-room world-class hotel which sits separately to the residential tower.
- Resort style residents amenity located on level 3.
- Curated materials, unique fittings and fixtures.
- Open, sculptural and enlightened apartment designs.
- Extensive greenery threaded throughout creating a building that breathes.
- Abundant natural light and cooling coastal breezes.

*Disclaimer: Images shown are artist impressions and indicative only of the generally intended development, not to be relied on as a guarantee or representation that a prospective purchaser will receive the view, development layout, specification and/or construction depicted. The actual view, development layout, specification and construction may vary materially from the image depicted.



*Artist Impression.

THE AMENITY.

Living at Paloma Paloma provides you with an array of incredible amenities right at your door step.

From Level 3, residents can experience a diversity of spaces to relax and enjoy including

- Private formal dining room
- Informal alfresco BBQ areas
- Resort-style swimming pool and cabanas
- Spa and steam room

This unique offering combined with sought-after local amenity means you can truly enjoy the best of relaxed coastal living.

In addition to this, residents can benefit from world-class hotel services on a pay-per-use basis.

- Valet parking
- Gym
- Day Spa
- Room Service
- Hotel concierge



*Artist Impression.

PRIVATE RESIDENCES.

Paloma Paloma offers a collection of private residences which have been designed to take advantage of its unique lifestyle offering.

Internal Features:

- Enhancing natural light, residences feature 2.7m ceilings to living areas with textured concrete ceilings.
- Extensive outdoor balconies extending indoor outdoor living and capturing seaside views.
- Premium finishes and fixtures including natural limestone tiles, stone benchtops and glass reinforced concrete kitchen bench.
- Coastal kitchens designed for entertaining featuring cork cabinetry, ASKO appliances, integrated fridge, induction cook-top, and circular feature island bench.
- Spacious master suite elevated by private outdoor Onsen Bath, terracotta feature tile to shower alcove and island vanity.
- Coastal breezes are enhanced by seamless glass sliding doors, glass balustrades, privacy screening and an external weather curtain.
- Ducted and zoned air conditioning, two high speed lifts and intercom security.



Sustainability Features:

- Curved concrete forms with extensive greenery threaded throughout creating a living edge and a building that breathes.
- Lush gardens are irrigated with recycled and filtered greywater.
- Solar panels ensure footprint is minimised.
- Fully-electric precinct enables 100% green energy.



LOCALITY.

Positioned on the Southern end of the Sunshine Coast, Paloma Paloma is located within easy reach from major arterial roads, convenient transport options including airports and train, local beaches, schools, health care service and retail amenity.

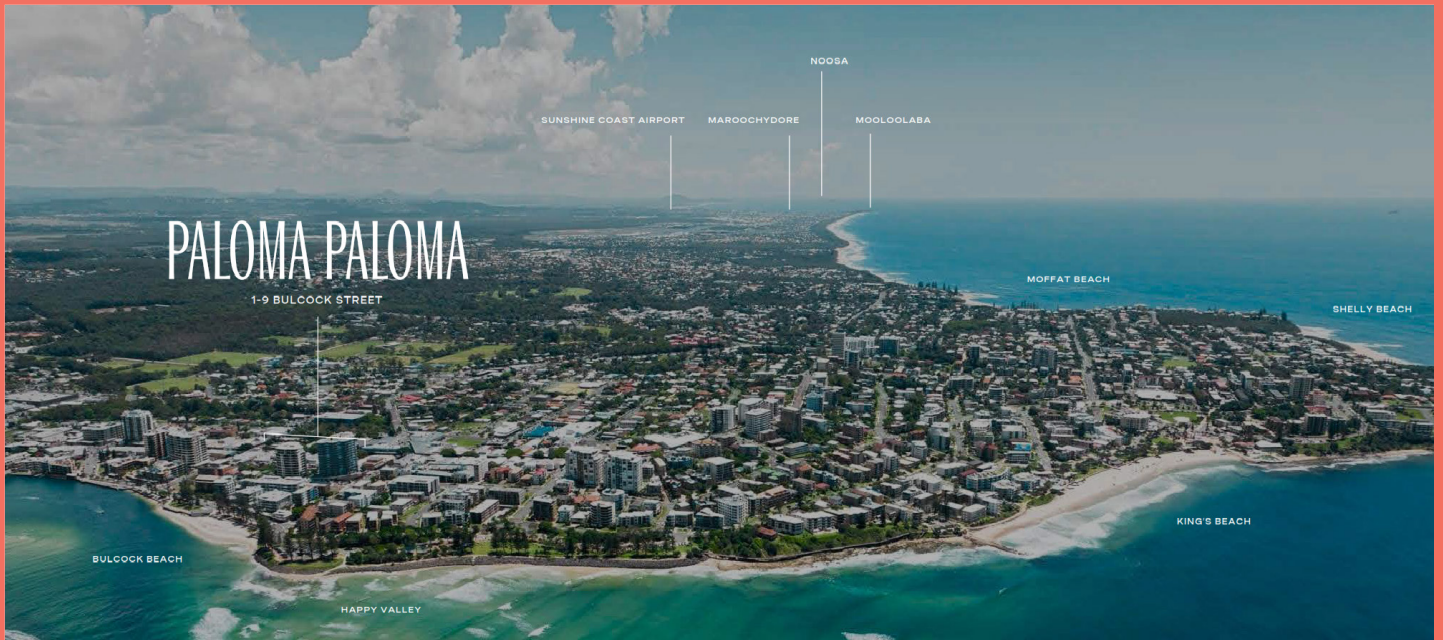

Transport:

- Sunshine Coast Airport (28km)
- Brisbane International Airport (91km)
- Landsborough Train Station (21km)
- Nicklin Way (5.8km)
- Bruce Highway

Health & Education:

- Caloundra State High (2.2km)

- Caloundra State School (2.2km)
- Caloundra Christian College (3.3km)
- The University of the Sunshine Coast (21.4km)
- Sunshine Coast University Hospital (9.6km)
- Sunshine Coast University Private Hospital (9.6km)
- Caloundra Hospital (2.6km)

Lifestyle Amenity:

- Bulcock Beach, Happy Valley, Kings Beach, Shelly Beach and Moffat Beach within 2km
- Sunshine Coast Turf Club (9.2km)
- Convention Centre (750m)
- Pelican Waters Golf Club (7.9km)
- Caloundra Golf Club (3.0km)
- Strand Cinema (170.0m)
- Caloundra Shopping Centre (1.8km)



*Artist Impression

*Disclaimer: Images shown are artist impressions and indicative only of the generally intended development, not to be relied on as a guarantee or representation that a prospective purchaser will receive the view, development layout, specification and/or construction depicted. The actual view, development layout, specification and construction may vary materially from the image depicted.